

New lower level retail

The most significant move in the Recommended Approach involves creating a new retail area by excavating beneath the Bay and York Street GO concourses and under the VIA Rail exit concourse. The new retail area would connect directly to the existing PATH and TTC concourses. The VIA concourse, and the Promenade area under the Great Hall and West Wing would remain at its existing level to preserve heritage characteristics.

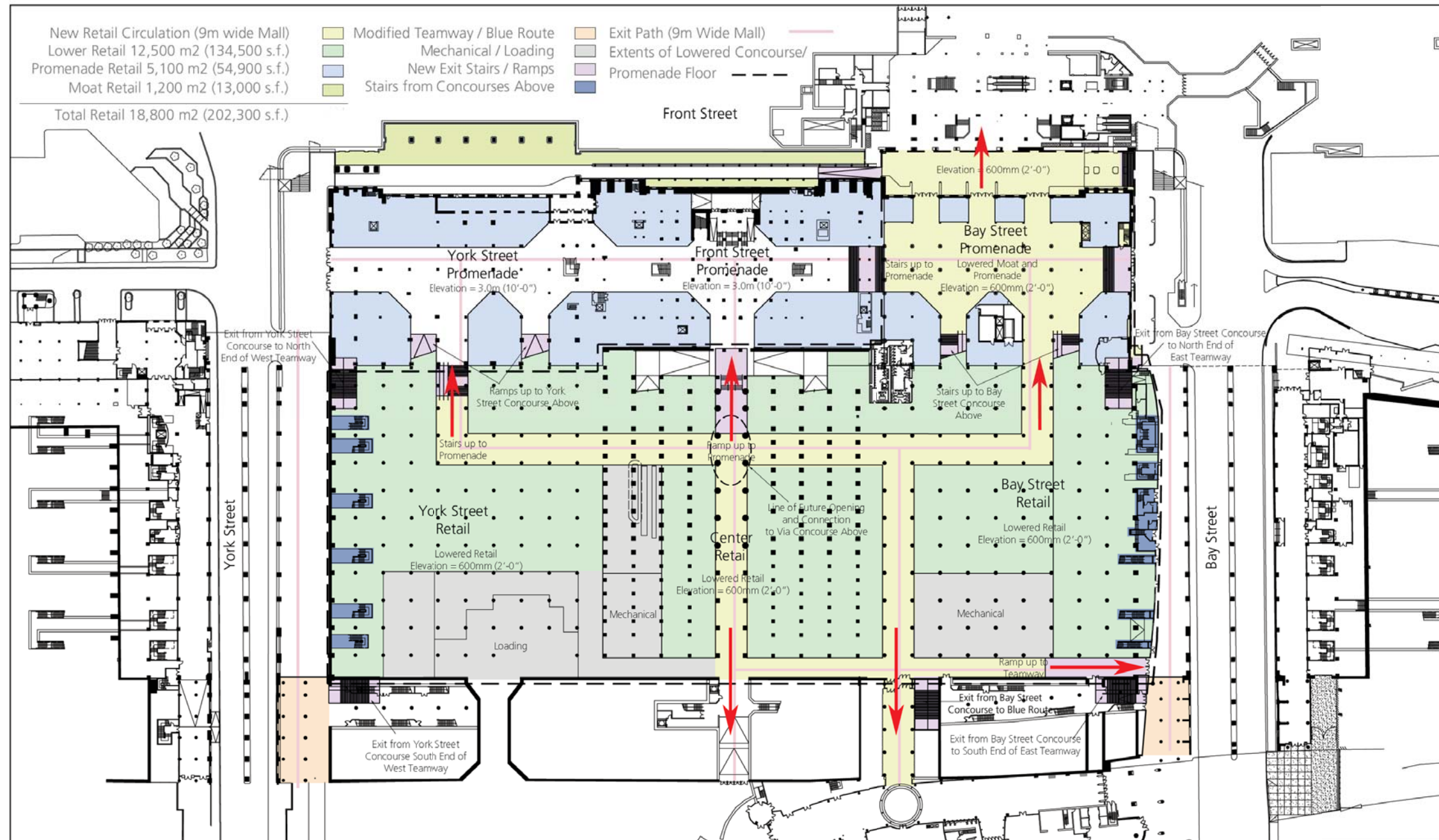

- 12,500 square meters of new lower level retail beneath Bay & Front Street and VIA Rail concourses
- Provision for more diverse shops and services. An option for offering the "Best of Toronto", locally-made items or Toronto-related services in a section of the retail area

Lower Retail Level

